

W:\Catalyze Energy\01 - Emery Solar\03 - Civil Design\05-Plan Set\EMERY-C-201-SITE PLAN-12.dwg
Printed: 8/16/2022 9:15 AM
GESTAMP FTGM SHEET SET R1.0.4

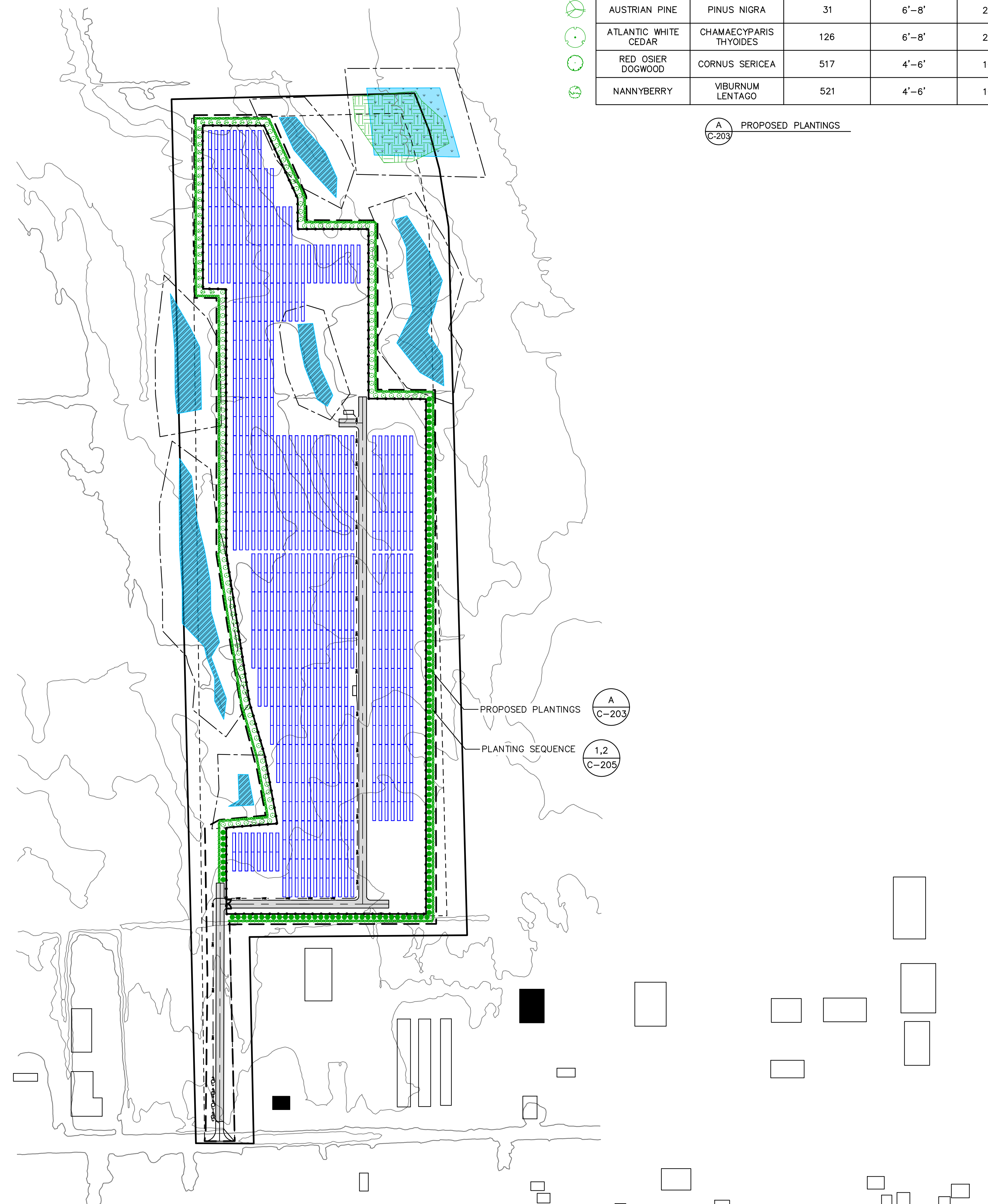
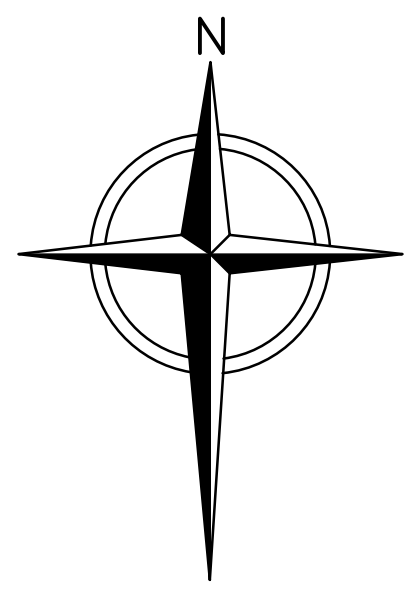

TREE SCHEDULE				
COMMON NAME	SPECIES	QUANTITY	HEIGHT AT PLANTING	PLANT SPACING
WHITE SPRUCE	PICEA GLAUCA	131	6'-8'	15' O.C.
AUSTRIAN PINE	PINUS NIGRA	31	6'-8'	20' O.C.
ATLANTIC WHITE CEDAR	CHAMAECYPARIS THYOIDES	126	6'-8'	20' O.C.
RED OSIER DOGWOOD	CORNUS SERICEA	517	4'-6'	10' O.C.
NANNYBERRY	VIBURNUM LENTAGO	521	4'-6'	10' O.C.

PROPOSED PLANTINGS

PROPOSED PLANTINGS

PLANTING SEQUENCE

LEGEND

- PROPERTY LINE
- 595 MAJOR CONTOURS (EXISTING)
- MINOR CONTOURS (EXISTING)
- NWI WETLANDS
- DELINEATED WETLANDS
- PROPOSED CHAIN LINK FENCE
- PROPOSED PERVIOUS ACCESS ROAD
- PROPOSED UNDERGROUND ELECTRIC
- ZONING SETBACKS/CONSTRAINTS
- 50' WETLAND BUFFER
- EXISTING TREE SURVEY
- PROPOSED PLANTINGS
- LIMITS OF DISTURBANCE
- ADJACENT EXISTING OCCUPIED RESIDENCE
- EXISTING STRUCTURE

GENERAL NOTES:

1. WILSON ENVIRONMENTAL TECHNOLOGIES INC. 2020. PRELIMINARY WETLAND DETERMINATION OF JONATHON AND INGA EMERY (PIN 36.00-1-28), WHITEHAVEN ROAD, TOWN OF GRAND ISLAND, ERIE COUNTY, NY. OCTOBER 16, 2020. WETLANDS ARE DEFINED AS WET 2020 IN LEGEND AND ON MAP.
2. BOUNDARY SURVEY WAS CONDUCTED BY NIAGARA BOUNDARY AND MAPPING SERVICES ON NOVEMBER 21, 2020.
3. BUILDING LOCATIONS SHOWN HEREON ARE APPROXIMATE. SOURCE: GOOGLE EARTH.
4. ZONING SETBACKS OBTAINED FROM TOWN OF GRAND ISLAND SOLAR CODE, 10-18-2021 BY LOCAL LAW NO. 9-2021.
5. THE TOTAL SITE ACREAGE IS 25.56 ACRES.
6. ELEVATION CONTOUR DATA OBTAINED FROM LIDAR DATA CATALOG.
7. TREE SURVEY CONDUCTED BY TETRA TECH ON JUNE 22, 2022.

0 150 300
SCALE IN FEET

NOT FOR CONSTRUCTION



6325 GUNPARK DRIVE, SUITE C
BOULDER, CO 80301
DT: +1 (888) 918-0771
WWW.CATALYZE.COM



IT IS A VIOLATION OF THE NEW YORK STATE EDUCATION LAW, ARTICLE 145, FOR ANY PERSON, UNLESS UNDER THE DIRECTION OF A NEW YORK STATE LICENSED PROFESSIONAL ENGINEER, TO ALTER AN ITEM ON THIS DOCUMENT IN ANY WAY.

STAMP:

EMERY SOLAR
PROPERTY OWNER:
EMERY, JONATHON &
EMERY, INGA
2599 WHITEHAVEN ROAD
GRAND ISLAND, NY 14072

PROJECT NUMBERS:
194-1378-0001

SHEET TITLE:
LANDSCAPING PLAN

SHEET SIZE:
ARCH "D"
24" X 36" (610 x 914)

THIS DOCUMENT IS THE PROPERTY OF TETRA TECH WHO HAS UNLIMITED RIGHTS. THIS DOCUMENT IS PROVIDED UPON CONDITION THAT IT WILL NEITHER BE REPRODUCED, COPIED, OR ISSUED TO A THIRD PARTY AND WILL BE USED SOLELY FOR THE ORIGINAL INTENDED PURPOSE.

NO.	REVISION	DATE	INIT.
A	PERMITTING	05/26/2022	AGF
B	PERMITTING	06/23/2022	AGF
C	PERMITTING	07/21/2022	AGF
D	PERMITTING	08/16/2022	AGF

DATE: 11/02/2020
DRAWN BY: AGF
ENGINEER: AGF
APPROVED BY: BMS

PROJECT PHASE:
DISCRETIONARY PERMITTING

SCALE: 1" = 150'

SHEET NO.:
C-203